



UNITED

SPRAY BOOTHS Ltd.

ULTIMATE PERFORMANCE FINISHING / REFINISHING



UNITED PRODUCTS

- Spray Paint Booths
- Make up air units
- Paint Mixing Rooms
- Paint Storage and Dispensing Units
 - Prep Stations
- Industrial process and curing ovens
 - Paint finishing system for Automotive Industries
- Paint Finishing system for Wood Working
- Paint Finishing for Window and Door Manufacturer Industries
- Paint Finishing for Metal Fabrication Industries
- Paint Finishing System for Mining
 - Powder Coating Paint Booth
 - Dust Collection System
- Industrial Ventilation System
 - Sand Blast Room
- High Pressure Continuous Washer Systems 2 to 7 Stages
 - Dip Tanks (Cleaning and Phosphating process application)
- Stainless Steel fabrication systems
 - Hot dipped Galvanizing system
- Hot High-Pressure washer system (Manual hand washer and Automatic system)
 - Spray Booth for Aviation
- Spray Booth for Transit, Trains, Bus, Truck and Fleet
 - Industrial Spray Booths with overhead Crane Slot and Conveyor Systems
 - Tube Axial Fans
 - Man Lift (Three axis)
 - Full Turn Key Solution
- Engineering Design, Manufacturing, Supply, Installation, Commissioning and Balancing of the System

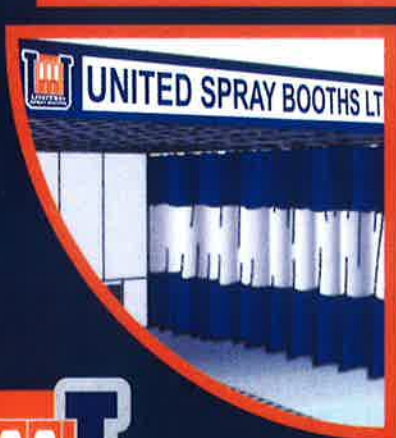
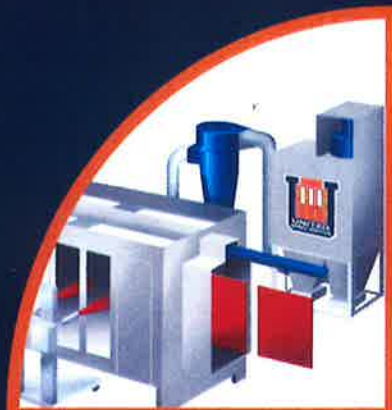

UNITED SPRAY BOOTHS Ltd.

101 Romina Drive, Vaughan, Ontario L4K 4Z9, Canada

Tel: (905) 738-5489 Fax: (905) 738-6751

Toll Free: 1(800) 901-3338

www.unitedspraybooths.com

info@unitedspraybooths.com



TWO OUTSTANDING CHOICES



DOWNDRAFT SPRAY BOOTH

BOOTH OPTIONS

- Booth basement or full raised floor with frame and grating.
- Wide Pit Frame or Additional Pit.
- 12'W x 14'W door also available.
- Drive through configuration - All Entrance and Exit doors are available with observation windows.
- Personal / Man door with observation window.
- Accelerated curing system.
- LED slim light Fixture 12" or 24" wide with 50 W, CCT 5000K.
- Observation Windows.
- Insulated spray booth with double layer of wall.
- Intake air ducting.
- Fire suppression system.
- Supply and installation complete turn key solution.
- Customization of Spray Booth as per Customer requirement.
- Different Spray Booth Models available - check with a United Spray Booth Representative at:
1-800-901-3338 or email on sales@unitedspraybooths.com

SEMI DOWNDRAFT SPRAY BOOTH

All Design and Construction as per:

- NFPA 33 Standard for Application Using Flammable Material.
- NFPA 86, Standard of Oven NEC and BOCA Guidelines.
- NFPA 91 Standards for Exhaust Systems.
- CSA B 149.1 10 National Gas and Propane Codes.
- ANSI / CSA C22-1-5 Electrical Codes, Part 1, Safety Standard for Electrical Installation.
- ETL Approved.
- Meets all State and Province Fire Codes.
- Meet to local Building Codes.
- United Spray Booths guarantees that our products meet or exceed all of the applicable codes related to the equipment.
- United Spray Booth's registered professional engineers regularly follow and contribute to the advancement of codes and standards that affect the Industries that we work in and help customers with design, manufacturing, fabrication, installation, commissioning and training.

SERVICE - personal consulting and design
DELIVERY - fast and flexible turn around
PRICE - most economical for quality system

DOWNDRAFT SPRAY BOOTH SPECIFICATIONS:

Construction

- White color with powder coat finishing.
- Single skin satin coated steel or Galvanized Steel G90.
- Full 14 ft wide or 16 ft wide, 2 or 3 Foot Plenum.
- Complete floor channel kit or floor tracking level.
- Full kit of hardware for Installation.

Doors

- Bi-Fold Door with observation windows.
- Door Size 10'W x 9'H.
- Personnel / Man door with observation window.

Air flow

- Full downdraft airflow for spray and cure.
- Controlled air flow ceiling.
- Complete air controlled by variable speed control system.
- Complete Floor pit frame and grating.
- Recirculation mode in cure cycle (optional).
- Raised floor (optional).

Filters

- Full set of intake / supply air filters - FRI / FR 560 (inside and roof filters).
- Full set of exhaust air filters fibre glass 36" to 72" wide.

Control

- Digital Temperature Control System.
- Remote Control panel & Main electrical panel.
- ETL approved.

Exhaust Fan

- Complete fan with non-sparkable blades.
- Motor available with various voltage 208 V-220V-230V-240V /1-3Ph V /1-3Ph/50 to 60 Hz. 460-480V / 3Ph / 50-60Hz., 575-600V / 3Ph / 50-60Hz.
- Size of the fan available as per length of the paint booth 30", 34", 42" and 48" diameter.

Light Fixtures

- All light fixtures are 4' x 2' with 110V / 247V / 370V.
- Cast wire glass / clear tempered glass.

Interlock Kits

- Air flow switch.
- Air Solenoid valve.
- Copper tubing.

Exhaust stack

- Exhaust Stack 12' Long.
- Roof flashing.
- Rain collar.
- Velocity cone or discharge head.
- Back draft damper.
- Insulated pipe (optional).

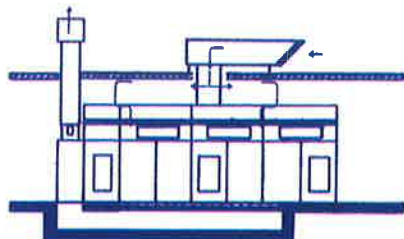

SEMI DOWNDRAFT SPRAY BOOTH SPECIFICATIONS:

Construction

- White color with powder coat finishing.
- Single skin satin coated steel or Galvanized Steel G90.
- Full 14 ft wide or 16 ft wide, 2 or 3 Foot Plenum.
- Complete floor channel kit or floor tracking level.
- Full kit of hardware for Installation.

Doors

- Bi-Fold Door with observation windows.
- Door Size 10'W x 9'H with observation windows.
- Personnel / Man door with observation window.

Air flow

- Full-Semi downdraft airflow for spray and cure.
- Controlled air flow ceiling.
- Complete air controlled by variable speed control system.
- Recirculation mode in cure cycle (optional).

Filters

- Full set of intake / supply air filters - FRI / FR 560 (inside and roof filters).
- Full set of exhaust air filters fibre glass paint arrestor.

Control

- Digital Temperature Control System.
- Remote Control panel & Main electrical panel.
- ETL approved.

Exhaust Fan

- Complete fan with non-sparkable blades.
- Motor available with various voltage 208 V-220V-230V-240V /1-3Ph V /1-3Ph/50 to 60 Hz. 460-480V / 3Ph / 50-60Hz., 575-600V / 3Ph / 50-60Hz.
- Size of the fan available as per length of the paint booth 30", 34", 42" and 48" diameter.

Light Fixtures

- All light fixtures are 4' x 2' with 110V / 247V / 370V.
- Cast wire glass / clear tempered glass.

Interlock Kits

- Air flow switch.
- Air Solenoid valve.
- Copper tubing.

Exhaust stack

- Exhaust Stack 12' Long.
- Roof flashing.
- Rain collar.
- Velocity cone or discharge head.
- Back draft damper.
- Insulated pipe (optional).

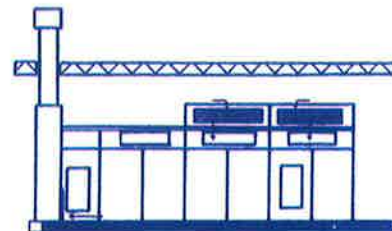

UNITED



UNITED SPRAY BOOTHS Ltd.

DOWN DRAFT SPRAY BOOTH



Outstanding performance: United Spray Booth Ltd.'s Down Draft Spray Booth exceeds automotive industry standards on Spray Booth Equipment. Every feature sets United Spray Booths Ltd. apart from the rest. Total finishing system including Make Up Air Unit and Spray Booth are ETL APPROVED.

Down Draft Spray Booth includes the following accessories: doors, lights, exhaust fan, ceiling intake filter. Useful for both solvent and waterborne paint. Down Draft Spray Booths can match any level of production desired by the Customer. Energy saving, high efficiency, air contamination control, variable air flow, less maintenance and ease of operation are many benefits of the Down Draft Spray Booth.

DIMENSION AND FEATURES

Air Flow	Length	Heat system	Internal Dimension	No of Exhaust Fans	4 -Tube Lights	Single -Row or Dual Row Pit Length
DOWN DRAFT SPRAY BOOTH	24'	Twin Flow Direct Fired MAU	24'L x 9'H x 14'W	24'4"L x 11'H x 14' 4"W	12	21'
	24'	Twin Flow Direct Fired MAU	24'L x 9'H x 16'W	24'4"L x 11'H x 16' 4"W	12	21'
	27'	Twin Flow Direct Fired MAU	27'L x 9'H x 14'W	27'4"L x 11'H x 14' 4"W	14	24'
	27'	Twin Flow Direct Fired MAU	27'L x 9'H x 16'W	27'4"L x 11'H x 16' 4"W	14	24'
	28'	Twin Flow Direct Fired MAU	28'L x 9'H x 14'W	28'4"L x 11'H x 14' 4"W	14	25'
	28'	Twin Flow Direct Fired MAU	28'L x 9'H x 16'W	28'4"L x 11'H x 16' 4"W	14	25'
	32'	Twin Flow Direct Fired MAU	32'L x 9'H x 14'W	32' 4"L x 11'H x 14' 4" W	16	28'
	32'	Twin Flow Direct Fired MAU	32'L x 9'H x 16'W	32' 4"L x 11'H x 16' 4"W	16	28'
	32'	Twin Flow Direct Fired MAU	32'L x 12'H x 16'W	32' 4"L x 15'H x 16' 4"W	16	28'

UNITED SPRAY BOOTHS LTD.

101 Romina Drive, Vaughan, Ontario, L4K 4Z9, Canada • Tel: (905) 738- 5489 • Fax: (905) 738-6751 • Toll Free: 1(800) 901-3338
www.unitedspraybooths.com • info@unitedspraybooths.com

STANDARD SPECIFICATION AND FEATURES:

Construction

- White color with powder coat finishing.
- Single skin satin coated steel or Galvanized Steel G90.
- Full 14 ft wide or 16 ft wide, 2 or 3 Foot Plenum.
- Complete floor channel kit or floor tracking level.
- Full kit of hardware for Installation.

Doors

- Bi-Fold Door with observation windows.
- Door Size 10'W x 9'H.
- Personnel / Man door with observation window.

Air flow

- Full downdraft airflow for spray and cure.
- Controlled air flow ceiling.
- Complete air controlled by variable speed control system.
- Complete Floor pit frame and grating.
- Recirculation mode in cure cycle (optional).
- Raised floor (optional).

Filters

- Full set of intake / supply air filters - FRI / FR 560 (inside and roof filters).
- Full set of exhaust air filters fibre glass 36" to 72" wide.

Control

- Digital Temperature Control System.
- Remote Control panel & Main electrical panel.
- ETL approved.

Exhaust Fan

- Complete fan with non-sparkable blades.
- Motor available with various voltage 208 V-220V-230V-240V /1-3Ph V /1-3Ph/50 to 60 Hz. 460-480V / 3Ph / 50-60Hz., 575-600V / 3Ph / 50-60Hz.
- Size of the fan available as per length of the paint booth 30", 34", 42" and 48" diameter.

Light Fixtures

- All light fixtures are 4' x 2' with 110V / 247V / 370V.
- Cast wire glass / clear tempered glass.

Interlock Kits

- Air flow switch.
- Air Solenoid valve.
- Copper tubing.

Exhaust stack

- Exhaust Stack 12' Long.
- Roof flashing.
- Rain collar.
- Velocity cone or discharge head.
- Back draft damper.
- Insulated pipe (optional).

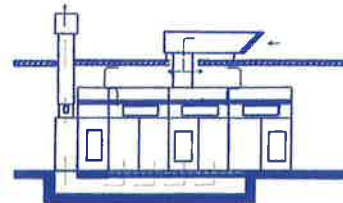

BOOTH OPTIONS:

- Booth basement or full raised floor with frame and grating.
- Wide Pit Frame or Additional Pit.
- 12'W x 14'W door also available.
- Drive through configuration - All Entrance and Exit doors are available with observation windows.
- Personal / Man door with observation window.
- Accelerated curing system.
- LED slim light Fixture 12" or 24" wide with 50 W, CCT 5000K.
- Observation Windows.
- Insulated spray booth with double layer of wall.
- Intake air ducting.
- Fire suppression system.
- Supply and installation complete turn key solution.
- Customization of Spray Booth as per Customer requirement.
- Different Spray Booth Models available - check with a United Spray Booth Representative at:
1-800-901-3338 or email on sales@unitedspraybooths.com

NOTE: All Design and Construction as per:

- NFPA 33 Standard for Application Using Flammable Material.
- NFPA 86, Standard of Oven NEC and BOCA Guidelines.
- NFPA 91 Standards for Exhaust Systems.
- CSA B 149.1 10 National Gas and Propane Codes.
- ANSI / CSA C22-1-5 Electrical Codes, Part 1, Safety Standard for Electrical Installation.
- ETL Approved.
- Meets all State and Province Fire Codes.
- Meet to local Building Codes.
- United Spray Booths guarantees that our products meet or exceed all of the applicable codes related to the equipment.
- United Spray Booth's registered professional engineers regularly follow and contribute to the advancement of codes and standards that affect the Industries that we work in and help customers with design, manufacturing, fabrication, installation, commissioning and training.



Intertek



UNITED SPRAY BOOTHS Ltd.

SEMI-DOWN DRAFT SPRAY BOOTH



High performance: United Spray Booth Ltd.'s Semi-Down Draft Spray Booth exceeds automotive industry standards on Spray Booth Equipment. Every feature sets United Spray Booths Ltd. apart from the rest. Total finishing system including Make Up Air Unit and Spray Booth are ETL APPROVED.

Semi-Down Draft Spray Booth includes the following accessories: doors, lights, exhaust fan, and ceiling intake filter. Useful for both solvent and waterborne paint. Semi-Down Draft Spray Booths can match any level of production desired by the Customer. Energy saving, high efficiency, air contamination control, variable air flow, less maintenance and ease of operation are many benefits of the Semi-Down Draft Spray Booth.

DIMENSION AND FEATURES

Air Flow	Length	Heat system	Internal Dimension	External Dimension	4 -Tube Lights
SEMI DOWN DRAFT SPRAY BOOTH	24'	TF Direct Fired Make Up Air Unit	21'L x 9'H x 14'W	24'4"L x 11'H x 14' 4"W	10
	24'	TF Direct Fired Make Up Air Unit	21'L x 9'H x 16'W	24'4"L x 11'H x 16' 4"W	10
	27'	TF Direct Fired Make Up Air Unit	24'L x 9'H x 14'W	27'4"L x 11'H x 14' 4"W	12
	27'	TF Direct Fired Make Up Air Unit	24'L x 9'H x 16'W	27'4"L x 11'H x 16' 4"W	12
	28'	TF Direct Fired Make Up Air Unit	25'L x 9'H x 14'W	28'4"L x 11'H x 14' 4"W	14
	28'	TF Direct Fired Make Up Air Unit	25'L x 9'H x 16'W	28'4"L x 11'H x 16' 4"W	14
	32'	TF Direct Fired Make Up Air Unit	28'L x 9'H x 14'W	32' 4"L x 11'H x 14' 4" W	16
	32'	TF Direct Fired Make Up Air Unit	28'L x 9'H x 16'W	32' 4"L x 11'H x 16' 4"W	16
	32'	TF Direct Fired Make Up Air Unit	28'L x 12'H x 16'W	32' 4"L x 15'H x 16' 4"W	16

UNITED SPRAY BOOTHS LTD.

101 Romina Drive, Vaughan, Ontario, L4K 4Z9, Canada • Tel: (905) 738- 5489 • Fax: (905) 738-6751 • Toll Free: 1(800) 901-3338
www.unitedspraybooths.com • info@unitedspraybooths.com

STANDARD SPECIFICATION AND FEATURES:

Construction

- White color with powder coat finishing.
- Single skin satin coated steel or Galvanized Steel G90.
- Full 14 ft wide or 16 ft wide, 2 or 3 Foot Plenum.
- Complete floor channel kit or floor tracking level.
- Full kit of hardware for Installation.

Doors

- Bi-Fold Door with observation windows.
- Door Size 10'W x 9'H with observation windows.
- Personnel / Man door with observation window.

Air flow

- Full-Semi downdraft airflow for spray and cure.
- Controlled air flow ceiling.
- Complete air controlled by variable speed control system.
- Complete Floor pit frame and grating.
- Recirculation mode in cure cycle (optional).
- Raised floor (optional).

Filters

- Full set of intake / supply air filters - FRI / FR 560 (inside and roof filters).
- Full set of exhaust air filters fibre glass paint arrestor.

Control

- Digital Temperature Control System.
- Remote Control panel & Main electrical panel.
- ETL approved.

Exhaust Fan

- Complete fan with non-sparkable blades.
- Motor available with various voltage 208 V-220V-230V-240V /1-3Ph V /1-3Ph/50 to 60 Hz. 460-480V / 3Ph / 50-60Hz., 575-600V / 3Ph / 50-60Hz.
- Size of the fan available as per length of the paint booth 30", 34", 42" and 48" diameter.

Light Fixtures

- All light fixtures are 4' x 2' with 110V / 247V / 370V.
- Cast wire glass / clear tempered glass.

Interlock Kits

- Air flow switch.
- Air Solenoid valve.
- Copper tubing.

Exhaust stack

- Exhaust Stack 12' Long.
- Roof flashing.
- Rain collar.
- Velocity cone or discharge head.
- Back draft damper.
- Insulated pipe (optional).

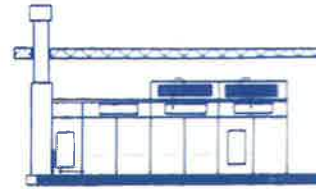

BOOTH OPTIONS:

- Drive through configuration - All Entrance and Exit doors are available with observation windows.
- Front door 12'W x 14'H as per Spray Booth size.
- Personal / Man door with observation window.
- Accelerated curing system.
- LED slim light Fixture 12" or 24" wide with 50 W, CCT 5000K.
- Observation Windows.
- Insulated spray booth with double layer of wall.
- Intake air ducting.
- Fire suppression system.
- Supply and installation complete turn key solution.
- Customization of Spray Booth as per Customer requirement.
- Different Spray Booth Models available - check with a United Spray Booth Representative at:
1-800-901-3338 or email on sales@unitedspraybooths.com

NOTE: All Design and Construction as per:

- NFPA 33 Standard for Application Using Flammable Material.
- NFPA 86, Standard of Oven NEC and BOCA Guidelines.
- NFPA 91 Standards for Exhaust Systems.
- CSA B 149.1 10 National Gas and Propane Codes.
- ANSI / CSA C22-1-5 Electrical Codes, Part 1, Safety Standard for Electrical Installation.
- ETL Approved.
- Meets all State and Province Fire Codes.
- Meet to local Building Codes.
- United Spray Booths guarantees that our products meet or exceed all of the applicable codes related to the equipment.
- United Spray Booth's registered professional engineers regularly follow and contribute to the advancement of codes and standards that affect the Industries that we work in and help customers with design, manufacturing, fabrication, installation, commissioning and training.



Intertek



UNITED SPRAY BOOTHS Ltd.

DOWN DRAFT TRUCK SPRAY BOOTH



Outstanding performance: United Spray Booth Ltd.'s Down Draft Spray Booth exceeds automotive, trucking and fleet industry standard on spray booths, including every feature that sets United Spray Booths apart from the rest. Total finishing system including make up air unit and spray booth are listed ETL APPROVED.

Down Draft Truck Spray Booth includes: doors, lights, exhaust fan, ceiling intake filter and air in coming design. Economizer useful for both solvent and waterborne features. Down Draft Spray Booth can match the level of Production level and customer capability, energy saving, high efficiency, air contamination control, variable air flow, less maintenance and ease of operation.

DIMENSION AND FEATURES

Air Flow	Length	Heat system	Internal Dimension	External Dimension	4 -Tube Lights	Single -Row or Duel Row Pit Length
DOWN DRAFT SPRAY BOOTH	36'	TF Direct Fired Make Up Air Unit	36'L x 16'H x 16'W	36'4"L x 18'H x 17'W	18	30'
	36'	TF Direct Fired Make Up Air Unit	36'L x 16'H x 18'W	36'4"L x 18'H x 19'W	24	30'
	48'	TF Direct Fired Make Up Air Unit	48'L x 16'H x 16'W	48'4"L x 18'H x 17'W	30	42'
	48'	TF Direct Fired Make Up Air Unit	48'L x 16'H x 18'W	48'4"L x 18'H x 19'W	36	42'
	56'	TF Direct Fired Make Up Air Unit	56'L x 16'H x 16'W	56'4"L x 18'H x 17'W	40	50'
	56'	TF Direct Fired Make Up Air Unit	56'L x 16'H x 18'W	56'4"L x 18'H x 19'W	48	50'
	60'	TF Direct Fired Make Up Air Unit	60'L x 16'H x 16'W	60'4"L x 18'H x 17'W	48	54'
	60'	TF Direct Fired Make Up Air Unit	60'L x 16'H x 18'W	60'4"L x 18'H x 19'W	56	54'
	72'	TF Direct Fired Make Up Air Unit	72'L x 16'H x 16'W	72'4"L x 18'H x 17'W	60	66'
72'	TF Direct Fired Make Up Air Unit	72'L x 16'H x 18'W	72'4"L x 18'H x 19'W	72	66'	

The intake plenum height can increase from 2 foot to 3-6"
 The Width of spray booth will increase when using man lift inside the paint booth.
 United Spray supplying and installation 3- Axis man lift as per customer requirement.

UNITED SPRAY BOOTHS LTD.

101 Romina Drive, Vaughan, Ontario, L4K 4Z9, Canada • Tel: (905) 738- 5489 • Fax: (905) 738-6751 • Toll Free: 1(800) 901-3338
www.unitedspraybooths.com • info@unitedspraybooths.com

STANDARD SPECIFICATION AND FEATURES:

Construction

- White color with powder coat finishing.
- Single skin satin coated steel or Galvanized Steel G90.
- Full 16 ft wide or 18 ft wide or 20 ft wide, 2 to 3.5 Foot Plenum.
- Complete floor channel kit or floor tracking level.
- Full kit of hardware for Installation.

Doors

- Bi-Fold Door with observation windows.
- Door Size 12'W x 14'H or 14'W x 14'H or 16'W x 16'H.
- Personnel / Man door with observation window.

Air flow

- Full downdraft airflow for spray and cure.
- Controlled air flow ceiling.
- Complete air controlled by variable speed control system.
- Complete Floor pit frame and grating.
- Recirculation mode in cure cycle (optional).

Filters

- Full set of intake / supply air filters - FRI / FR 560 (inside and roof filters).
- Full set of exhaust air filters fibre glass 36" to 72" wide.

Control

- Digital Temperature Control System.
- Remote Control panel & Main electrical panel.
- ETL approved.

Exhaust Fan

- Complete fan with non-sparkable blades.
- Motor available with various voltage 208 V-220V-230V-240V /1-3Ph V /1-3Ph/50 to 60 Hz. 460-480V / 3Ph / 50-60Hz., 575-600V / 3Ph / 50-60Hz.
- Size of the fan available as per length of the paint booth 30", 34", 42", 48", 54" and 60" diameter.

Light Fixtures

- All light fixtures are 4' x 2' with 110V / 247V / 370V.
- Cast wire glass / clear tempered glass.

Interlock Kits

- Air flow switch.
- Air Solenoid valve.
- Copper tubing.

Exhaust stack

- Exhaust Stack 20' Long.
- Roof flashing.
- Rain collar.
- Velocity cone or discharge head.
- Back draft damper.
- Insulated pipe (optional).



BOOTH OPTIONS:

- Booth basement or full raised floor with frame and grating.
- Wide Pit Frame or Additional Pit.
- Drive through configuration - All Entrance and Exit doors are available with observation windows.
- Personal / Man door with observation window.
- Accelerated curing system.
- LED slim light Fixture 12" or 24" wide with 50 W, CCT 5000K.
- Observation Windows.
- Insulated spray booth with double layer of wall.
- Intake air ducting.
- Fire suppression system.
- Supply and installation complete turn key solution.
- Customization of Spray Booth as per Customer requirement.
- Different Spray Booth Models available - check with a United Spray Booth Representative at:
1-800-901-3338 or email on sales@unitedspraybooths.com

NOTE: All Design and Construction as per:

- NFPA 33 Standard for Application Using Flammable Material.
- NFPA 86, Standard of Oven NEC and BOCA Guidelines.
- NFPA 91 Standards for Exhaust Systems.
- CSA B 149.1 10 National Gas and Propane Codes.
- ANSI / CSA C22-1-5 Electrical Codes, Part 1, Safety Standard for Electrical Installation.
- ETL Approved.
- Meets all State and Province Fire Codes.
- Meet to local Building Codes.
- United Spray Booths guarantees that our products meet or exceed all of the applicable codes related to the equipment.
- United Spray Booth's registered professional engineers regularly follow and contribute to the advancement of codes and standards that affect the Industries that we work in and help customers with design, manufacturing, fabrication, installation, commissioning and training.



Intertek



UNITED SPRAY BOOTHS Ltd.

SIDE DOWN DRAFT TRUCK SPRAY BOOTH



Outstanding performance: United Spray Booth Ltd.'s Side Down Draft Spray Booth exceeds automotive industry standard on spray booths, including every feature that sets United Spray Booths apart from the rest. Total finishing system including make up air unit and spray booth are listed ETL APPROVED.

Side Down Draft Truck Spray Booth includes: doors, lights, exhaust fan, ceiling intake filter and air in coming design. Economizer useful for both solvent and waterborne features. Down Draft Spray Booth can match the level of Production level and customer capability, energy saving, high efficiency, air contamination control, variable air flow, less maintenance and ease of operation.

DIMENSION AND FEATURES

Air Flow	Length	Heat system	Internal Dimension	External Dimension	4 -Tube Lights	Single -Row or Duel Row Pit Length
DOWN DRAFT SPRAY BOOTH	36'	TF Direct Fired Make Up Air Unit	36'L x 16'H x 16'W	36'4"L x 18'H x 22'W	18	No Need
	36'	TF Direct Fired Make Up Air Unit	36'L x 16'H x 18'W	36'4"L x 18'H x 24'W	24	No Need
	48'	TF Direct Fired Make Up Air Unit	48'L x 16'H x 16'W	48'4"L x 18'H x 22'W	30	No Need
	48'	TF Direct Fired Make Up Air Unit	48'L x 16'H x 18'W	48'4"L x 18'H x 24'W	36	No Need
	56'	TF Direct Fired Make Up Air Unit	56'L x 16'H x 16'W	56'4"L x 18'H x 22'W	40	No Need
	56'	TF Direct Fired Make Up Air Unit	56'L x 16'H x 18'W	56'4"L x 18'H x 24'W	48	No Need
	60'	TF Direct Fired Make Up Air Unit	60'L x 16'H x 16'W	60'4"L x 18'H x 22'W	48	No Need
	60'	TF Direct Fired Make Up Air Unit	60'L x 16'H x 18'W	60'4"L x 18'H x 24'W	56	No Need
	72'	TF Direct Fired Make Up Air Unit	72'L x 16'H x 16'W	72'4"L x 18'H x 22'W	60	No Need
72'	TF Direct Fired Make Up Air Unit	72'L x 16'H x 18'W	72'4"L x 18'H x 24'W	72	No Need	

The intake plenum height can increase from 2 foot to 3-6"
 The Width of spray booth will increase when using man lift inside the paint booth.
 United Spray supplying and installation 3- Axis man lift as per customer requirement.

UNITED SPRAY BOOTHS LTD.

101 Romina Drive, Vaughan, Ontario, L4K 4Z9, Canada • Tel: (905) 738- 5489 • Fax: (905) 738-6751 • Toll Free: 1(800) 901-3338
www.unitedspraybooths.com • info@unitedspraybooths.com

STANDARD SPECIFICATION AND FEATURES:

Construction

- White color with powder coat finishing.
- Single skin satin coated steel or Galvanized Steel G90.
- Full 16 ft wide or 18 ft wide or 20 ft wide, 2 to 3.5 Foot Plenum.
- Complete floor channel kit or floor tracking level.
- Full kit of hardware for Installation.

Doors

- Bi-Fold Door or Six-Fold Door with observation windows.
- Door Size 12'W x 14'H or 14'W x 14'H or 16'W x 16'H.
- Personnel / Man door with observation window.

Air flow

- Full downdraft airflow for spray and cure.
- Controlled air flow ceiling.
- Complete air controlled by variable speed control system.
- Complete two left and right side with exhaust filter frame.
- Recirculation mode in cure cycle (optional).

Filters

- Full set of intake / supply air filters - FRI / FR 560 (inside and roof filters).
- Full set of exhaust air filters fibre glass 36" to 72" wide or paint arrestors.

Control

- Digital Temperature Control System.
- Remote Control panel & Main electrical panel.
- ETL approved.

Exhaust Fan

- Complete fan with non-sparkable blades.
- Motor available with various voltage 208 V-220V-230V-240V /1-3Ph V /1-3Ph/50 to 60 Hz. 460-480V / 3Ph / 50-60Hz., 575-600V / 3Ph / 50-60Hz.
- Size of the fan available as per length of the paint booth 30", 34", 42", 48", 54" and 60" diameter.

Light Fixtures

- All light fixtures are 4' x 2' with 110V / 247V / 370V.
- Cast wire glass / clear tempered glass.

Interlock Kits

- Air flow switch.
- Air Solenoid valve.
- Copper tubing.

Exhaust stack

- Exhaust Stack 20' Long.
- Roof flashing.
- Rain collar.
- Velocity cone or discharge head.
- Back draft damper.
- Insulated pipe (optional).



BOOTH OPTIONS:

- Drive through configuration - All Entrance and Exit doors are available with observation windows.
- Personal / Man door with observation window.
- Accelerated curing system.
- LED slim light Fixture 12" or 24" wide with 50 W, CCT 5000K.
- Observation Windows.
- Insulated spray booth with double layer of wall.
- Intake air ducting.
- Fire suppression system.
- Supply and installation complete turn key solution.
- Customization of Spray Booth as per Customer requirement.
- Different Spray Booth Models available - check with a United Spray Booth Representative at:
1-800-901-3338 or email on sales@unitedspraybooths.com

NOTE: All Design and Construction as per:

- NFPA 33 Standard for Application Using Flammable Material.
- NFPA 86, Standard of Oven NEC and BOCA Guidelines.
- NFPA 91 Standards for Exhaust Systems.
- CSA B 149.1 10 National Gas and Propane Codes.
- ANSI / CSA C22-1-5 Electrical Codes, Part 1, Safety Standard for Electrical Installation.
- ETL Approved.
- Meets all State and Province Fire Codes.
- Meet to local Building Codes.
- United Spray Booths guarantees that our products meet or exceed all of the applicable codes related to the equipment.
- United Spray Booth's registered professional engineers regularly follow and contribute to the advancement of codes and standards that affect the Industries that we work in and help customers with design, manufacturing, fabrication, installation, commissioning and training.



Intertek



UNITED SPRAY BOOTHS Ltd.

SEMI-DOWN DRAFT / CROSS DRAFT TRUCK SPRAY BOOTH



High performance: United Spray Booth Ltd.'s Semi-Down Draft / Cross Draft Truck Spray Booth exceeds trucking and fleet industry standards on Spray Booths Equipment. Every feature sets United Spray Booths Ltd. apart from the rest. Total finishing system including Make Up Air Unit and Spray Booth are ETL APPROVED.

Semi-Down Draft / Cross Draft Truck Spray Booth includes the following accessories: doors, lights, exhaust fan, and ceiling intake filter. Useful for both solvent and waterborne paint. Semi-Down Draft / Cross Draft Truck Spray Booths can match any level of production desired by the Customer. Energy saving, high efficiency, air contamination control, variable air flow, less maintenance and ease of operation are many benefits of the Semi-Down Draft / Cross Draft Truck Spray Booth.

DIMENSION AND FEATURES

Air Flow	Length	Heat system	Internal Dimension	External Dimension	4 -Tube Lights	Single -Row or Duel Row Pit Length
DOWN DRAFT SPRAY BOOTH	36'	TF Direct Fired Make Up Air Unit	33'L x 16'H x 16'W	36'4"L x 18'H x 17'W	18	No need
	36'	TF Direct Fired Make Up Air Unit	33'L x 16'H x 18'W	36'4"L x 18'H x 19'W	24	No need
	48'	TF Direct Fired Make Up Air Unit	45'L x 16'H x 16'W	48'4"L x 18'H x 17'W	30	No need
	48'	TF Direct Fired Make Up Air Unit	45'L x 16'H x 18'W	48'4"L x 18'H x 19'W	36	No need
	56'	TF Direct Fired Make Up Air Unit	52'L x 16'H x 16'W	56'4"L x 18'H x 17'W	40	No need
	56'	TF Direct Fired Make Up Air Unit	52'L x 16'H x 18'W	56'4"L x 18'H x 19'W	48	No need
	60'	TF Direct Fired Make Up Air Unit	56'L x 16'H x 16'W	60'4"L x 18'H x 17'W	48	No need
	60'	TF Direct Fired Make Up Air Unit	56'L x 16'H x 18'W	60'4"L x 18'H x 19'W	56	No need
	72'	TF Direct Fired Make Up Air Unit	68'L x 16'H x 16'W	72'4"L x 18'H x 17'W	60	No need
72'	TF Direct Fired Make Up Air Unit	68'L x 16'H x 18'W	72'4"L x 18'H x 19'W	72	No need	

The intake plenum height can increase from 2 foot to 3-6"

The Width of spray booth will increase when using man lift inside the paint booth.

United Spray supplying and installation 3- Axis man lift as per customer requirement.

UNITED SPRAY BOOTHS LTD.

101 Romina Drive, Vaughan, Ontario, L4K 4Z9, Canada • Tel: (905) 738- 5489 • Fax: (905) 738-6751 • Toll Free: 1(800) 901-3338
www.unitedspraybooths.com • info@unitedspraybooths.com

STANDARD SPECIFICATION AND FEATURES:

Construction

- White color with powder coat finishing.
- Single skin satin coated steel or Galvanized Steel G90.
- Full 14 ft wide or 16 ft wide, 2 to 3 Foot Plenum.
- Complete floor channel kit or floor tracking level.
- Full kit of hardware for Installation.

Doors

- Bi-Fold Door or Six-Fold Door with observation windows.
- Door Size 12'W x 14'H or 14'W x 14'H or 16'W x 16'H.
- Personnel / Man door with observation window.

Air flow

- Full downdraft airflow for spray and cure.
- Controlled air flow ceiling.
- Complete air controlled by variable speed control system.
- Complete Floor pit frame and grating.
- Recirculation mode in cure cycle (optional).

Filters

- Full set of intake / supply air filters - FRI / FR 560 (inside and roof filters).
- Full set of exhaust air filters fibre glass 36" to 72" wide or paint arrestors.

Control

- Digital Temperature Control System.
- Remote Control panel & Main electrical panel.
- ETL approved.

Exhaust Fan

- Complete fan with non-sparkable blades.
- Motor available with various voltage 208 V-220V-230V-240V /1-3Ph V /1-3Ph/50 to 60 Hz. 460-480V / 3Ph / 50-60Hz., 575-600V / 3Ph / 50-60Hz.
- Size of the fan available as per length of the paint booth 30", 34", 42" and 48" diameter.

Light Fixtures

- All light fixtures are 4' x 2' with 110V / 247V / 370V,
- Cast wire glass / clear tempered glass.

Interlock Kits

- Air flow switch.
- Air Solenoid valve.
- Copper tubing.

Exhaust stack

- Exhaust Stack 20' Long.
- Roof flashing.
- Rain collar.
- Velocity cone or discharge head.
- Back draft damper.
- Insulated pipe (optional).



BOOTH OPTIONS:

- Drive through configuration - All Entrance and Exit doors are available with observation windows.
- Personal / Man door with observation window.
- Accelerated curing system.
- LED slim light Fixture 12" or 24" wide with 50 W, CCT 5000K.
- Observation Windows.
- Insulated spray booth with double layer of wall.
- Intake air ducting.
- Fire suppression system.
- Supply and installation complete turn key solution.
- Customization of Spray Booth as per Customer requirement.
- Different Spray Booth Models available - check with a United Spray Booth Representative at:
1-800-901-3338 or email on sales@unitedspraybooths.com

NOTE: All Design and Construction as per:

- NFPA 33 Standard for Application Using Flammable Material.
- NFPA 86, Standard of Oven NEC and BOCA Guidelines.
- NFPA 91 Standards for Exhaust Systems.
- CSA B 149.1 10 National Gas and Propane Codes.
- ANSI / CSA C22-1-5 Electrical Codes, Part 1, Safety Standard for Electrical Installation.
- ETL Approved.
- Meets all State and Province Fire Codes.
- Meet to local Building Codes.
- United Spray Booths guarantees that our products meet or exceed all of the applicable codes related to the equipment.
- United Spray Booth's registered professional engineers regularly follow and contribute to the advancement of codes and standards that affect the Industries that we work in and help customers with design, manufacturing, fabrication, installation, commissioning and training.



Intertek



UNITED SPRAY BOOTHS Ltd.

AUTOMOTIVE PREP-STATION



United Spray Booth Ltd.'s manufacture single and multi-bay prep and/or limited finishing station. Starting standard is a one car bay. Expandable to an unlimited number of work bays. Add a heated paint booth air makeup system and process jobs simultaneously. The more work bays, the faster jobs can be processed.

Available in Downdraft, Side Downdraft and Semi Downdraft.

Air is recirculated 100% until the user decides to exhaust air to the outdoors. Other pre-areas exhaust to the exterior full-time.

DIMENSION AND FEATURES

Air Flow	No of cars use	Heat system	Dimension	4 -Tube Lights	No of Exhaust Fans
SEMI DOWN DRAFT OR DOWN DRAFT PREPSTATION	1	TF Direct Fired Make Up Air Unit	21'D x 11'H x 12' to 14'W	6	1
	2	TF Direct Fired Make Up Air Unit	21'D x 11'H x 24'W	12	2
	3	TF Direct Fired Make Up Air Unit	21'D x 11'H x 36'W	18	3
	4	TF Direct Fired Make Up Air Unit	21'D x 11'H x 48'W	24	4
	5	TF Direct Fired Make Up Air Unit	21'D x 11'H x 60'W	30	5
	6	TF Direct Fired Make Up Air Unit	21'D x 11'H x 72'W	36	6
	7	TF Direct Fired Make Up Air Unit	21'D x 11'H x 84'W	42	7
	8	TF Direct Fired Make Up Air Unit	21'D x 11'H x 96'W	48	8
	9	TF Direct Fired Make Up Air Unit	21'D x 11'H x 108'W	54	9
	10	TF Direct Fired Make Up Air Unit	21'D x 11'H x 120'W	60	10
<p>Each Prepstation section can increase with 2' and depth 3' (depth 24')</p> <p>For Down Draft Prep Station , Each section will have pit 18' L</p> <p>All plastic curtains will in two color with complete installation kits.</p>					

UNITED SPRAY BOOTHS LTD.

101 Romina Drive, Vaughan, Ontario, L4K 4Z9, Canada • Tel: (905) 738- 5489 • Fax: (905) 738-6751 • Toll Free: 1(800) 901-3338
www.unitedspraybooths.com • info@unitedspraybooths.com

STANDARD SPECIFICATION AND FEATURES:

Semi Down Draft Prep Station

This Prep station has a solid back configuration that delivers air in a front to back semi downdraft pattern. Air is delivered to the workspace through the ceiling and air is exhausted out the rear of the workspace through a filtered back wall. On a heated application, full heat recycle through a rear plenum gives you an efficient high-performance semi downdraft limited finishing station without sacrificing energy efficiency.

Side Down Draft Prep Station with Drive Through Configuration

The Drive Through Configuration delivers air in a left to right or right to left semi downdraft pattern. Air is delivered to the work space through the ceiling and air is exhausted out the workspace through filtered side walls just like a side draft paint booth. Floor plan and shop flow are optimized by allowing the car to be prepped and/or painted and then driven through to the next step. On a heated application, full heat recycle through a side plenum gives you an efficient high-performance semi downdraft limited finishing station without sacrificing efficiency.

Downdraft Prep Station

A downdraft configuration Prep Station that delivers air through the ceiling and air is exhausted through the floor underneath the vehicle and user. Available with heat and full heat recycle. Also available with a raised steel basement for a pit-less downdraft configuration giving you the best of both worlds: a true downdraft paint booth system and no concrete pit excavation necessary.



EXHAUST AIR ARRANGEMENT

Each prep station work bay has its own exhaust filter section and exhaust fan and controls can be designed for simultaneous or independent operation. Each bay fully recirculated 100% of the air with damper control with damper motor until the user decides to exhaust to the exterior. This saves hundreds in energy costs by not exhausting conditioned air to the outdoors all the time.

CONTROL PANEL

United Spray Booth Ltd.'s prep station control panel lets the user turn on lights to work without having the airflow turned on if desired. The motor and fan are turned on independently and recirculate 100% of the air being moved. Each station have two modes, one is prep and second is sanding mode.

BOOTH OPTIONS:

- Booth basement or full raised floor with frame and grating.
- Wide Pit Frame or Additional Pit.
- LED slim light Fixture 12" or 24" wide with 50 W, CCT 5000K.
- Observation Windows.
- Insulated spray booth with double layer of wall.
- Intake air ducting.
- Fire suppression system.
- Supply and installation complete turn key solution.
- Customization of Spray Booth as per Customer requirement.
- Different Spray Booth Models available - check with a United Spray Booth Representative at:
1-800-901-3338 or email on sales@unitedspraybooths.com

NOTE: All Design and Construction as per:

- NFPA 33 Standard for Application Using Flammable Material.
- NFPA 86, Standard of Oven NEC and BOCA Guidelines.
- NFPA 91 Standards for Exhaust Systems.
- CSA B 149.1 10 National Gas and Propane Codes.
- ANSI / CSA C22-1-5 Electrical Codes, Part 1, Safety Standard for Electrical Installation.
- ETL Approved.
- Meets all State and Province Fire Codes.
- Meet to local Building Codes.
- United Spray Booths guarantees that our products meet or exceed all of the applicable codes related to the equipment.
- United Spray Booth's registered professional engineers regularly follow and contribute to the advancement of codes and standards that affect the Industries that we work in and help customers with design, manufacturing, fabrication, installation, commissioning and training.



UNITED SPRAY BOOTHS Ltd.

ULTIMATE PERFORMANCE FINISHING / REFINISHING SYSTEMS
THE MOST INEXPENSIVE PAINT FINISHING SYSTEM

CROSS DRAFT



Excellent starter spray booth for automotive or industrial use

The Square Economy Cross Draft Spray Booth is designed to be used as an automotive or industrial paint finishing application system.

This economic model is as efficient as the more expensive spray booths. For automotive applications this model has the capacity to complete several paint finishing jobs per day without heat. The production rate can be increased with the addition of an air make up unit.

MEETS: OBC, OFC, OML, OME, OSHA, NFPA, UL, BOCA CODES
Designed and manufactured by **UNITED SPRAY BOOTH Ltd.**

CUSTOM DESIGNED BOOTHS MANUFACTURED TO MEET YOUR REQUIREMENTS
UNITS INSTALLED AND SERVICED BY FACTORY TRAINED CREW

UNITED SPRAY BOOTHS Ltd.

380 Bradwick Drive, Concord, Ontario, L4K 2W4

Tel: (905) 738-5489 Fax: (905) 738-6751

Toll Free: 1(800) 901-3338

www.unitedspraybooths.com

info@unitedspraybooths.com

Distributed By:

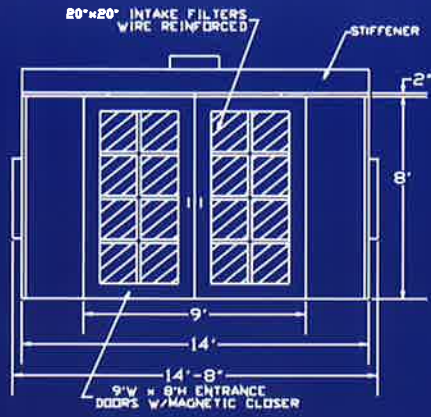

Front View

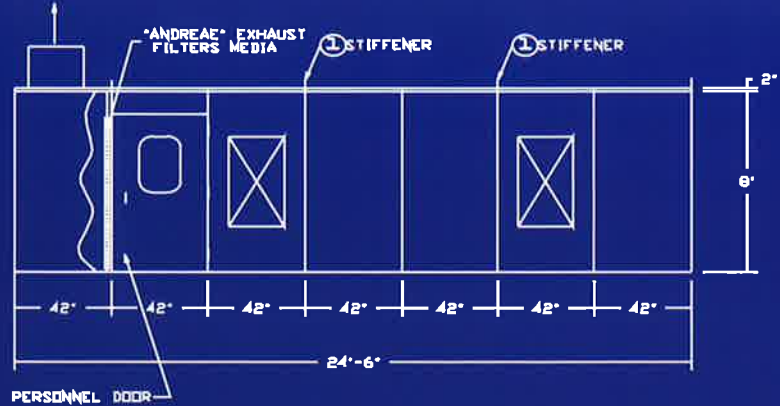

Side View

CROSS DRAFT SPRAY BOOTH

ULTIMATE PERFORMANCE FINISHING / REFINISHING SYSTEMS

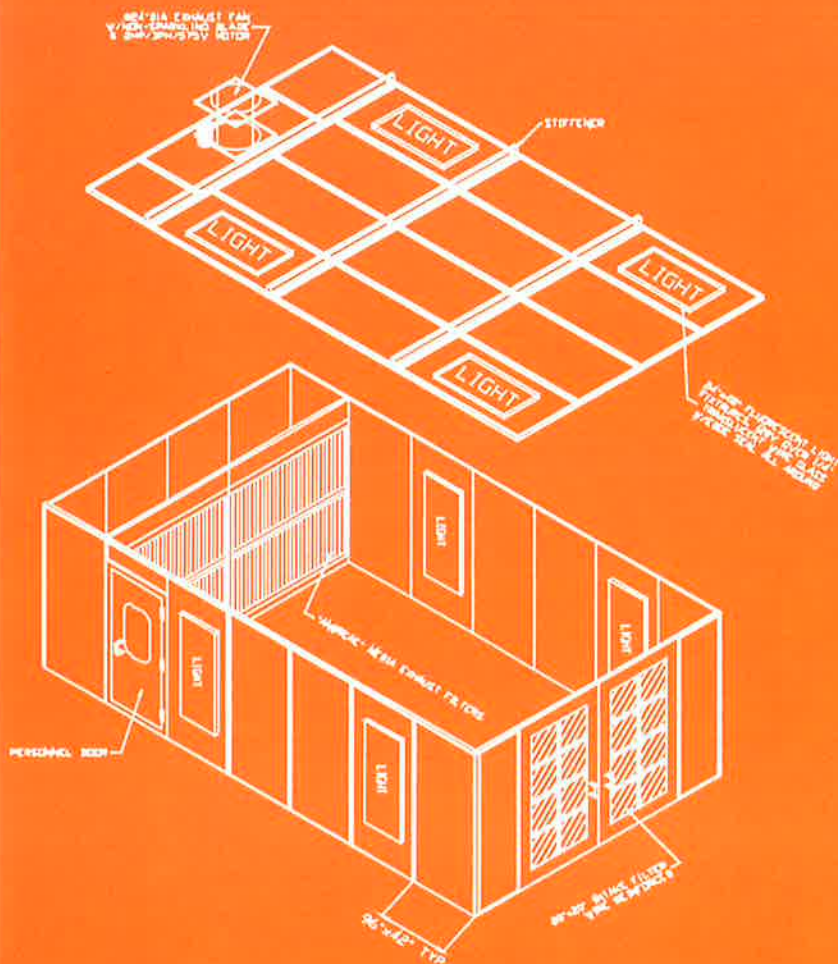

Features:

- 24'6" X 8' X 14'
- two front doors 8' x 4'6" each
- one side door 2'4" X 6'8"
- 18 gauge, 4-sided satin coat steel panels

Filters:

- exhaust: two banks Andrea filters
- intake: sixteen 20 X 20 ssp.

Fan:

- 24" diameter, rated at 8000 CFM (Free air)
- motor: 2HP, 3-phase, 575 included, other types available on request (specify voltage)

Lighting:

- eight 4-tube fluorescent type units (Less tubes)

Exhaust Stack:

- to be arranged according to installation and location



UNITED SPRAY BOOTHS Ltd.

ULTIMATE PERFORMANCE FINISHING / REFINISHING SYSTEMS

TURBO DRAFT



This new booth by **UNITED** is introduced for both automotive and industrial paint application. The supply filters are located on the front top and sides of the booth, thus minimizing dust from the front doors where dust migration usually takes place. The front door is the tri-fold type, similar to our downdraft and semi downdraft spray booth; a definite plus when monitoring the interior of the booth while in operation. A man door is also included with this booth as well as a separate service door in the filter section.

The **Turbo-Draft** spray booth by **UNITED** is simply elegant and efficient. If you would like to own an economical quality booth then **Turbo-Draft** is the answer. . . .

UNITED SPRAY BOOTHS Ltd.

380 Bradwick Drive, Concord, Ontario, L4K 2W4

Tel: (905) 738-5489 Fax: (905) 738-6751

Toll Free: 1(800) 901-3338

www.unitedspraybooths.com

info@unitedspraybooths.com

Distributed By:

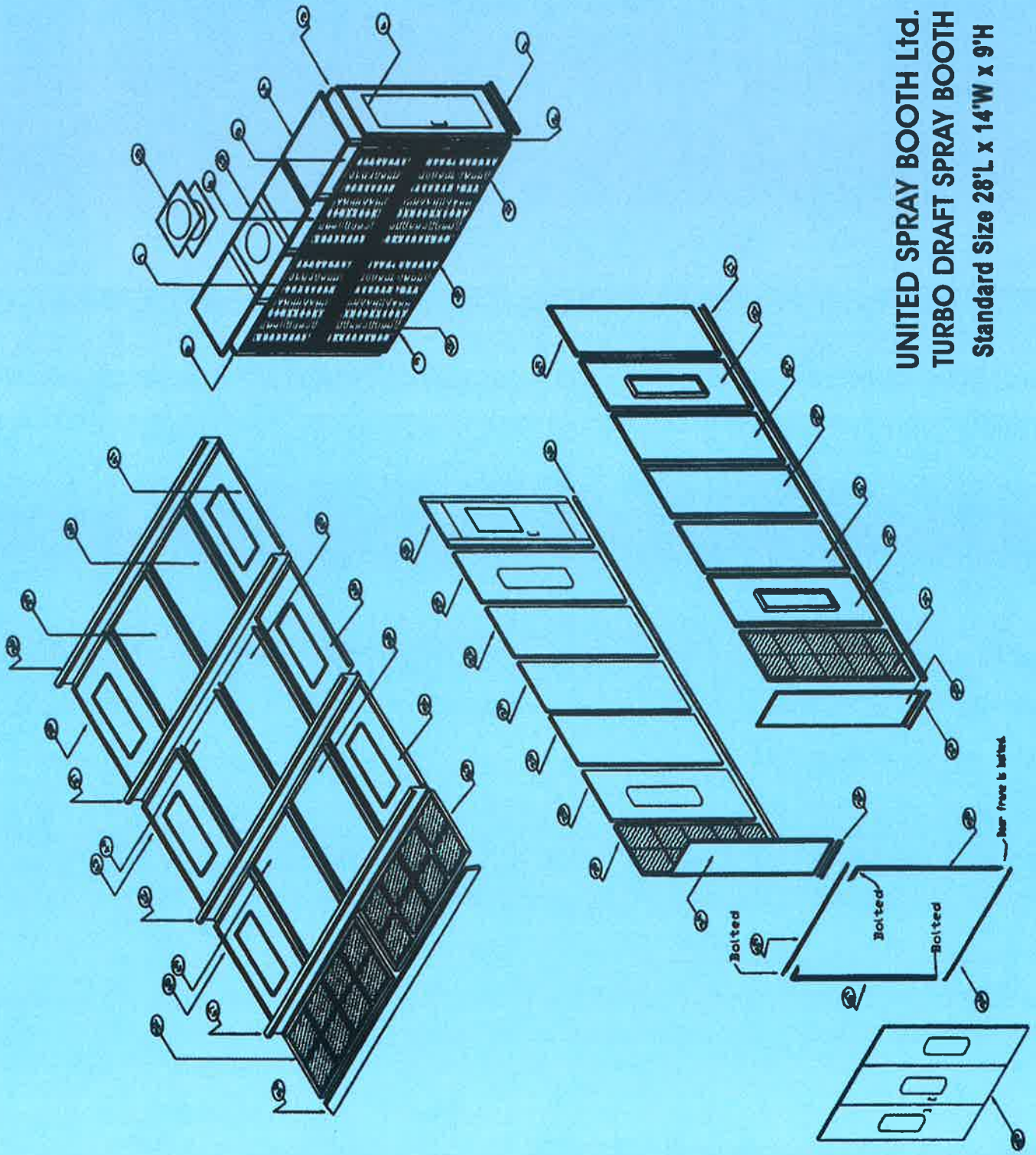

UNITED SPRAY BOOTH Ltd.
TURBO DRAFT SPRAY BOOTH
Standard Size 28'L x 14'W x 9'H



UNITED SPRAY BOOTHS Ltd.

ULTIMATE PERFORMANCE FINISHING / REFINISHING SYSTEMS

OPEN FACE



The economical solution to remove overspray efficiently

- Filters trap air-borne particles and are easy to replace
- Self-supporting structure made of pre-fabricated galvanized steel panels
- Quality components used through-out
- Exhaust fan and lights included
- Exhaust pipe, roof flashing and weather caps available
- Custom fabricated to suit your needs
- All booths manufactured by UNITED meet the requirements of NFPA, Department of Labour, UL and OSHA, BOCA, Codes

ALSO AVAILABLE – Interlock Valve System 115V (no fan, no spray)
Customer designs also accepted

UNITED SPRAY BOOTHS Ltd.

380 Bradwick Drive, Concord, Ontario, L4K 2W4

Tel: (905) 738-5489 Fax: (905) 738-6751

Toll Free: 1(800) 901-3338

www.unitedspraybooths.com

info@unitedspraybooths.com

Distributed By:

OPEN FACE SPRAY BOOTH

MODELS	DIMENSIONS			LIGHTS	FAN	MOTOR
	A	B	C			
A-777	7'0"	7'0"	7'0"	1	24"	2 HP
A-1077	10'0"	7'0"	7'0"	2	24"	2 HP
A-1277	12'0"	7'0"	7'0"	2	30"	3 HP

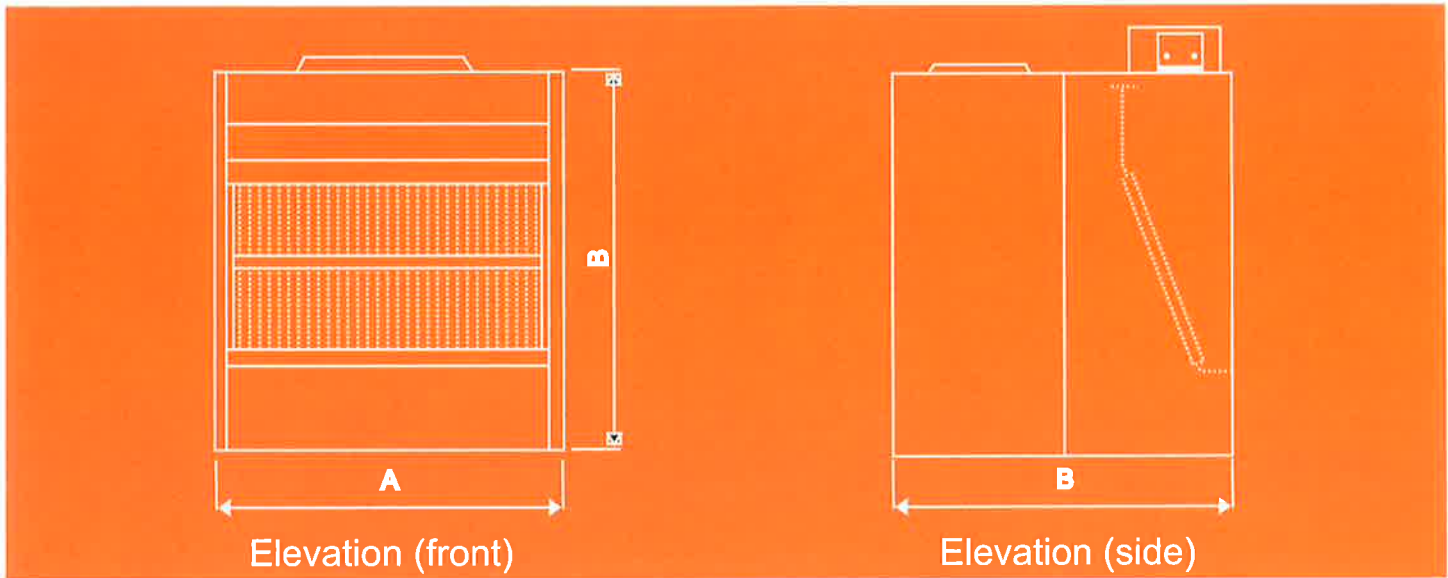

- Models:** A-777, A-1077 and A-1277 are dry filtered, open face industrial spray booths. Custom Spray Booths available.
- Walls & Ceiling:** 18 gauge galvanized or satin coat pre-fabricated steel panels
- Filter Banks:** Two rows 36" wide by full length of spray booth andrea filters
- Exhaust Fan:** 24" or 30" diameter fan with non-sparking blades, belts and drive pulleys
- Fan Motor:** 2 HP or 3 HP 600 volt, 3 phase or 220V single phase
- Lights:** 1 or 2, fluorescent , 48" or 24", 4 tube (tubes not included) 110 volts, general purpose, closed end
- Light Glass:** ¼" translucent wire glass window
- Hardware:** 5/16" x ¾" self tapping screws

UNITED SPRAY BOOTHS Ltd.

380 Bradwick Drive, Concord, Ontario, L4K 2W4

Tel: (905) 738-5489 Fax: (905) 738-6751

Toll Free: 1(800) 901-3338

www.unitedspraybooths.com

info@unitedspraybooths.com

FILTER SERVICE ON REQUEST WIDE VARIETY AVAILABLE

PROFESSIONAL INSTALLATION ON REQUEST

The economical solution to remove overspray efficiently



UNITED SPRAY BOOTHS Ltd.

**AIR MAKE-UP SYSTEMS
FOR SPACE HEATING AND SPRAY BOOTH APPLICATIONS**



Reliability, energy, efficiency, high quality and affordable prices are a must in today's HVAC environment. Twin Flow Air Systems Ltd. provide this by offering complete, ready-to-install units in several versions as well as large choice options. This enables the customer to select with the assistance of Twin Flow's engineering staff, the proper unit for the specific application, thus providing the most cost energy efficient unit available.

Twin Flow's direct fired air make up units have been designed to provide customers with a reliable air heating system, capable of providing from 4,000 CFM - 100,000 CFM of air (for applications out of this range, please contact Twin Flow).

Efficiency with 97%, clean combustion air. Specially designed profile plates and well mixed air before burner section for recirculating units are some of the advantages.

Upright and recirculating models as well as standard and optional performance and safety features, high quality parts and workmanship provide more reasons to utilize a Twin Flow Air Make Up Systems for your application.

UNITED SPRAY BOOTHS Ltd.

380 Bradwick Drive, Concord, Ontario, L4K 2W4

Tel: (905) 738-5489 Fax: (905) 738-6751

Toll Free: 1(800) 901-3338

www.unitedspraybooths.com

info@unitedspraybooths.com

Distributed By:



UNITED SPRAY BOOTHS Ltd.

AIR MAKE-UP SYSTEMS

FOR SPACE HEATING AND SPRAY BOOTH APPLICATIONS

ORDERING INFORMATION

Provide Twin Flow direct gas heaters as specified:

Model No. : TF.....
Capacity :CFM
E.S.P. : "W.C.
Discharge Temp. :F
Fuel :
El. Supply :V/.....Ph/.....Hz
Gas inlet press. :
Discharge :

CASING

Heater casing is fabricated of heavy duty 18 Gauge satin coated steel. Base frame is integral iron channel construction. The unit is equipped with large access doors that make the blower, motor, drives, burner and controls fully accessible. All units are insulated with 1" high quality insulation. Units are equipped with a water resistant control enclosure housing for all electrical controls and gas manifold. The units are painted with two-component epoxy coating.

BLOWER

Units are equipped with SWDI and DWDI forward curved centrifugal blowers, dynamically balanced, complete with a polished ground shaft. Drivers are adjustable to within 5% above or below midpoint r.p.m. up to 10 HP. On larger units, blowers are supplied with fixed drives.

BURNER

The units are fitted with high efficiency burners. Burners are direct fired. The velocity of the air stream is maintained between 1600 & 4500 FPM. The arrangement and shape of the air holes in the baffles attached to the burner casting provide the injection of proper combustion air at all rates of firing. Over 30 to 1 available. The burner section is manifolded individually to accomplish a desired capacity. These burners are brand name, precision built, sturdy, compact and maintenance free.

DAMPER

Units come complete with a two position, parallel blades, motorized inlet damper. Blades are roll formed, triple V groove 18 gauge galvanized steel with molded synthetic bearings. All dampers are sealed and low leak.

ELECTRICAL

Units are internally fully factory wired and tested. Units are equipped with non-fused disconnect switch in NEMA housing. Field wiring connections are easily made between the numbered terminal strips.

UNITED SPRAY BOOTHS Ltd.

380 Bradwick Drive, Concord, Ontario, L4K 2W4

Tel: (905) 738-5489 Fax: (905) 738-6751

Toll Free: 1(800) 901-3338

www.unitedspraybooths.com

info@unitedspraybooths.com

